

Acct ID: 564540 MTL: 092W140000500 Date: 7/28/25 Appr: MLH Prop Class: 551 RMV Prop Class: 551 501
 Situs: 7512 HUNSAKER RD SE TURNER OR 97392 MaSaNh: 07 06 000 Unit: 107193 Year: 2025

Last Date Appraised: 08/12/2021 Appraiser: MATT LORD Retag: Y N Tag info:
 Owner: LUCAS, RANDY J & LUCAS, REBECCA Roll Type: R
 Cycle Tag Sales Verification Other: Clean up Inspection level: 1 2 3 4 LCB TTO INSP AV: 903366
 RMV Land: 520250 RMV Imp: 1379040 RMV Total: 1899290 MAV: 848120 MSAV: 55246 SAV: 120187
 Comment: 8/12/2021 L4 CL

update Inventory

Input MLH 8/19/25

Notations

RP/MS	Code	Description
MS	ZONED	FARM EFU ZONED
RP	ZONED	FARM EFU ZONED

OSDs

Count	Code	Description	RMV	Code Area	Exception
2	SAA	SA OSD - AVERAGE	50000	05545	0

Land

Site: 2	Code Area: 05545	Size: 1.00 Acres	Use Code: 005	Zone: REST	SAV Use: 011	Exception: 0
Class:	Value Source: Farm Homesite	Description:			RMV: 16320	Exception: Y N
Adjustment(s):	GSOIL, IRR		Fire Patrol:	Description:		
Comments: Liability year - 2009 / 550040						
Site: 4	Code Area: 05545	Size: 1.00 Acres	Use Code: 005	Zone: REST	SAV Use: 011	Exception: 0
Class:	Value Source: Farm Homesite	Description:			RMV: 16320	Exception: Y N
Adjustment(s):	GSOIL, IRR		Fire Patrol:	Description:		
Comments: Liability year - 2009 //09-10: GW39 changed land type per Excel analysis//550040						
Site: 5	Code Area: 05545	Size: 5.06 Acres	Use Code: 005	Zone: REST	SAV Use: 011	Exception: 0
Class: 2BISS	Value Source: Farm Use - EFU	Description: TWO BENCH IRR SOUTH SPECIAL			RMV: 94960	Exception: Y N
Adjustment(s):	GSOIL, IRR		Fire Patrol:	Description:		
Comments: Liability year - 1980 / 550040						
Site: 6	Code Area: 05545	Size: 17.08 Acres	Use Code: 005	Zone: REST	SAV Use: 011	Exception: 0
Class: 4BISS	Value Source: Farm Use - EFU	Description: FOUR BENCH IRR SPECIAL SOUTH			RMV: 292650	Exception: Y N
Adjustment(s):	GSOIL, IRR		Fire Patrol:	Description:		
Comments: Liability year - 1980 / 550040: 01-02: COMBINED LAND SEGS - SAME SOIL CLASS, SAME LIAB YR, 17.08 TTL ACRES						

Improvements - Residence / Manufactured Structures

Bldg: 8 Code Area: 05545 Stat Class: 467 Year Blt: 1995 Eff Year Blt: 1995 Sq.Ft: 1774 % Complete: 100
 Desc: MANUF STRUCT, CLASS 6, 26' THROUGH 28' WIDE DOUBLE Dimensions: RMV: 84470
 Func Obsc: 100 Econ %: 100 Other %: 100 Exception: 0 Adjust: Adjust RMV: 0

Floors

Type	Class	Display Group	Floor Size	Beds	Baths	Yr Blt	Eff Yr Blt	Inventory	Exception
First Floor	6	Finished	1774	3	FB-2	1995	1995	SKRT+, ROOF, KIT-, BATH - 2, HVAC+	Y N

Accessories

Description	Class	Size SqFt	Eff Yr Blt	RMV	Quantity	Exception
CONCRETE DRIVEWAY	6	144	1995	206	0	Y N
CONCRETE DRIVEWAY	6	780	1995	1115	0	Y N
PATIO	6	300	1995	726	0	Y N
ROOF EXTENSION OR PATIO COVER	6	360	1995	4594	0	Y N

Bldg: 12 Code Area: 05545 Stat Class: 162 - Year Blt: 2007 Eff Year Blt: 2007 Sq.Ft: 3389 % Complete: 100
 Desc: Multi Story above grade Dimensions: RMV: 800670
 Func Obsc: 100 Econ %: 100 Other %: 100 Exception: 0 Adjust: Adjust RMV: 0

Floors

Type	Class	Display Group	Floor Size	Beds	Baths	Yr Blt	Eff Yr Blt	Inventory	Exception
First Floor	6 -	Finished	2823	3	FB-3	2007	2007	BATH - 3, KIT, FP - 2, ROOF, HVAC, BATH+	Y N
Attic	6 -	Finished	566	0	0	2007	2007	HVAC, ROOF	Y N
Garage Attached	6	Finished	753	0	0	2007	2007	ROOF	Y N

Accessories

Description	Class	Size SqFt	Eff Yr Blt	RMV	Quantity	
CONCRETE DRIVEWAY	6	8850	2007	26461	0	Exception: Y N
PATIO	6	103	2007	521	0	Exception: Y N
PATIO	6	170	2007	860	0	Exception: Y N
PATIO	6	372	2007	1882	0	Exception: Y N
PATIO	6	630	2007	3188	0	Exception: Y N
ROOF EXTENSION OR PATIO COVER	6	103	2007	2748	0	Exception: Y N
ROOF EXTENSION OR PATIO COVER	6	372	2007	9925	0	Exception: Y N

Already JIS

Improvements - Accessory Buildings

Bldg: 2 Code Area: 05545 Stat Class: 353 Year Blt: 1986 Eff Year Blt: 1995 Sq.Ft: 3056 % Complete: 100
 Desc: Machine Shed (MS) Dimensions: ~~58x24~~ 52x32 RMV: 13220
 Func Obsc: 100 Econ %: 100 Other %: 100 Exception: 0 Adjust: Adjust RMV: 0 I/O

Floors

Type	Class	Display Group	Floor Size	Beds	Baths	Yr Blt	Eff Yr Blt	Inventory	
Machine Shed	5	Finished	3056	0	0	1986	1995	FAIR	Exception: Y N

Accessories

Description	Class	Size SqFt	Eff Yr Blt	RMV	Quantity	
CONCRETE DRIVEWAY	5	1820	1995	3440	0	Exception: Y N

Bldg: 5 Code Area: 05545 Stat Class: 351 Year Blt: 1981 Eff Year Blt: 1995 Sq.Ft: 1204 % Complete: 100
 Desc: General Purpose Building (GB) Dimensions: ~~30x14~~ 28x28 RMV: 7730
 Func Obsc: 100 Econ %: 100 Other %: 100 Exception: 0 Adjust: Adjust RMV: 0 I/O

Floors

Type	Class	Display Group	Floor Size	Beds	Baths	Yr Blt	Eff Yr Blt	Inventory	
General Purpose Bldg	4	Finished	1204	0	0	1981	1995	FAIR	Exception: Y N

Accessories

Description	Class	Size SqFt	Eff Yr Blt	RMV	Quantity	
No accessory data available						

Bldg: 6 Code Area: 05545 Stat Class: 353 Year Blt: 1986 Eff Year Blt: 2000 Sq.Ft: 7800 % Complete: 100
 Desc: Machine Shed (MS) Dimensions: 156x50 RMV: 53770
 Func Obsc: 100 Econ %: 100 Other %: 100 Exception: 0 Adjust: Adjust RMV: 0 N/C

Floors

Type	Class	Display Group	Floor Size	Beds	Baths	Yr Blt	Eff Yr Blt	Inventory	
Machine Shed	5	Finished	7800	0	0	1986	2000	FAIR	Exception: Y N

Accessories

Description	Class	Size SqFt	Eff Yr Blt	RMV	Quantity	
No accessory data available						

Bldg: 7 Code Area: 05545 Stat Class: 301 Year Blt: 2000 Eff Year Blt: 2000 Sq.Ft: 98800 % Complete: 100
 Desc: Accessory Improvements & Misc. Dimensions: RMV: 98800
 Func Obsc: 100 Econ %: 100 Other %: 100 Exception: 0 Adjust: Adjust RMV: 0

Floors

Type	Class	Display Group	Floor Size	Beds	Baths	Yr Blt	Eff Yr Blt	Inventory	
Building Structure	0	Finished	98800	0	0	2000	2000		Exception: Y N

Change to HC's make MAU

Accessories

Description	Class	Size SqFt	Eff Yr Blt	RMV	Quantity	
No accessory data available						

Bldg: 13 Code Area: 05545 Stat Class: 351 Year Blt: 2007 Eff Year Blt: 2007 Sq.Ft: 1800 % Complete: 100
 Desc: General Purpose Building (GB) Dimensions: 30x60 RMV: 30090
 Func Obsc: 100 Econ %: 100 Other %: 100 Exception: 0 Adjust: Adjust RMV: 0 I/O

Floors

Type	Class	Display Group	Floor Size	Beds	Baths	Yr Blt	Eff Yr Blt	Inventory	
General Purpose Bldg	6	Finished	1800	0	0	2007	2007	FAIR	Exception: Y N

MAU

Accessories

Description	Class	Size SqFt	Eff Yr Blt	RMV	Quantity	
No accessory data available						

Bldg: 14 Code Area: 05545 Stat Class: 352 Year Blt: 2005 Eff Year Blt: 2007 Sq.Ft: 10080 % Complete: 100

Desc: Utility Building (UB) Dimensions: 84x120 RMV: 112360
 Func Obsc: 100 Econ %: 100 Other %: 100 Exception: 0 Adjust: Adjust RMV: 0

Change to MS *I/O*

Floors Type	Class	Display Group	Floor Size	Beds	Baths	Yr Blt	Eff Yr Blt	Inventory
Utility Building	5	Finished	10080	0	0	2005	2007	FAIR

Exception: Y N

Accessories

Description	Class	Size SqFt	Eff Yr Blt	RMV	Quantity
No accessory data available					

Bldg: 15 Code Area: 05545 Stat Class: 352 Year Blt: 2005 Eff Year Blt: 2007 Sq.Ft: 2880 % Complete: 100
 Desc: Utility Building (UB) Dimensions: 120x24 RMV: 42250
 Func Obsc: 100 Econ %: 100 Other %: 100 Exception: 0 Adjust: Adjust RMV: 0

change to MG *I/O*

Floors Type	Class	Display Group	Floor Size	Beds	Baths	Yr Blt	Eff Yr Blt	Inventory
Utility Building	5	Finished	2880	0	0	2005	2007	

Exception: Y N

Accessories

Description	Class	Size SqFt	Eff Yr Blt	RMV	Quantity
CONCRETE DRIVEWAY	5	2880	2007	8554	0

Exception: Y N

Bldg: 16 Code Area: 05545 Stat Class: 321 Year Blt: 2007 Eff Year Blt: 2007 Sq.Ft: 1600 % Complete: 100
 Desc: Hay Cover (HC) Dimensions: 50x32 RMV: 12680
 Func Obsc: 100 Econ %: 100 Other %: 100 Exception: 0 Adjust: Adjust RMV: 0

I/O

Floors Type	Class	Display Group	Floor Size	Beds	Baths	Yr Blt	Eff Yr Blt	Inventory
Hay Cover	5	Finished	1600	0	0	2007	2007	FAIR

Exception: Y N

Accessories

Description	Class	Size SqFt	Eff Yr Blt	RMV	Quantity
CONCRETE DRIVEWAY	5	1100	2007	3267	0

Exception: Y N

Bldg: 17 Code Area: 05545 Stat Class: 341 Year Blt: 2008 Eff Year Blt: 2008 Sq.Ft: 320 % Complete: 100
 Desc: Multi Purpose Shed (MP) Dimensions: 16x20 RMV: 5240
 Func Obsc: 100 Econ %: 100 Other %: 100 Exception: 0 Adjust: Adjust RMV: 0

n/u

Floors Type	Class	Display Group	Floor Size	Beds	Baths	Yr Blt	Eff Yr Blt	Inventory
Multi-Purpose Bldg	5	Finished	320	0	0	2008	2008	FAIR

Exception: Y N

Accessories

Description	Class	Size SqFt	Eff Yr Blt	RMV	Quantity
No accessory data available					

Bldg: 18 Code Area: 05545 Stat Class: 352 Year Blt: 2008 Eff Year Blt: 2008 Sq.Ft: 8040 % Complete: 100
 Desc: Utility Building (UB) Dimensions: 80x60, 60x54 RMV: 93590
 Func Obsc: 100 Econ %: 100 Other %: 100 Exception: 0 Adjust: Adjust RMV: 0

I/O

Floors Type	Class	Display Group	Floor Size	Beds	Baths	Yr Blt	Eff Yr Blt	Inventory
Utility Building	5	Finished	8040	0	0	2008	2008	FAIR

Exception: Y N

Accessories

Description	Class	Size SqFt	Eff Yr Blt	RMV	Quantity
No accessory data available					

Bldg: 19 Code Area: 05545 Stat Class: 321 Year Blt: Eff Year Blt: 2006 Sq.Ft: 420 % Complete: 100
 Desc: Hay Cover (HC) Dimensions: 30x14 RMV: 2030
 Func Obsc: 100 Econ %: 100 Other %: 100 Exception: 0 Adjust: Adjust RMV: 0

I/O

Floors Type	Class	Display Group	Floor Size	Beds	Baths	Yr Blt	Eff Yr Blt	Inventory
Hay Cover	5	Finished	420	0	0	0	2006	FAIR

Exception: Y N

Accessories

Description	Class	Size SqFt	Eff Yr Blt	RMV	Quantity
No accessory data available					

Bldg: 20 Code Area: 05545 Stat Class: 341 Year Blt: Eff Year Blt: 2005 Sq.Ft: 140 % Complete: 100
 Desc: Multi Purpose Shed (MP) Dimensions: 14x10 RMV: 2510

Func Obsc: 100	Econ %: 100	Other %: 100	Exception: 0	Adjust:	Adjust RMV: 0	N/C			
Floors									
Type	Class	Display Group	Floor Size	Beds	Baths	Yr Blt	Eff Yr Blt	Inventory	
Multi-Purpose Bldg	5	Finished	140	0	0	0	2005	FAIR	Exception: Y N

Accessories						
Description	Class	Size SqFt	Eff Yr Blt	RMV	Quantity	
No accessory data available						

Bldg: 21 Code Area: 05545 Stat Class: 355 Year Blt: Eff Year Blt: 2007 Sq.Ft: 192 % Complete: 100
 Desc: Lean-to Heavy (LTH) Dimensions: 16x12 RMV: 860
 Func Obsc: 100 Econ %: 100 Other %: 100 Exception: 0 Adjust: Adjust RMV: 0 N/C

Floors								
Type	Class	Display Group	Floor Size	Beds	Baths	Yr Blt	Eff Yr Blt	Inventory
Lean-to Heavy Duty	4	Finished	192	0	0	0	2007	Exception: Y N

Accessories						
Description	Class	Size SqFt	Eff Yr Blt	RMV	Quantity	
No accessory data available						

Bldg: 22 Code Area: 05545 Stat Class: 354 Year Blt: Eff Year Blt: 2008 Sq.Ft: 644 % Complete: 100
 Desc: Lean-to Light (LTL) Dimensions: 46x14 RMV: 1770
 Func Obsc: 100 Econ %: 100 Other %: 100 Exception: 0 Adjust: Adjust RMV: 0 N/C

Floors								
Type	Class	Display Group	Floor Size	Beds	Baths	Yr Blt	Eff Yr Blt	Inventory
Lean-to Light Duty	4	Finished	644	0	0	0	2008	Exception: Y N

Accessories						
Description	Class	Size SqFt	Eff Yr Blt	RMV	Quantity	
No accessory data available						

Bldg: 23 Code Area: 05545 Stat Class: 354 Year Blt: Eff Year Blt: 2008 Sq.Ft: 200 % Complete: 100
 Desc: Lean-to Light (LTL) Dimensions: 20x10 RMV: 730
 Func Obsc: 100 Econ %: 100 Other %: 100 Exception: 0 Adjust: Adjust RMV: 0 N/C

Floors									
Type	Class	Display Group	Floor Size	Beds	Baths	Yr Blt	Eff Yr Blt	Inventory	
Lean-to Light Duty	4	Finished	200	0	0	0	2008	FAIR	Exception: Y N

Accessories						
Description	Class	Size SqFt	Eff Yr Blt	RMV	Quantity	
No accessory data available						

Bldg: 24 Code Area: 05545 Stat Class: 355 Year Blt: Eff Year Blt: 1995 Sq.Ft: 432 % Complete: 100
 Desc: Lean-to Heavy (LTH) Dimensions: 24x18 RMV: 1220
 Func Obsc: 100 Econ %: 100 Other %: 100 Exception: 0 Adjust: Adjust RMV: 0 N/C

Floors								
Type	Class	Display Group	Floor Size	Beds	Baths	Yr Blt	Eff Yr Blt	Inventory
Lean-to Heavy Duty	4	Finished	432	0	0	0	1995	Exception: Y N

Accessories						
Description	Class	Size SqFt	Eff Yr Blt	RMV	Quantity	
No accessory data available						

Bldg: 25 Code Area: 05545 Stat Class: 355 Year Blt: Eff Year Blt: 1995 Sq.Ft: 384 % Complete: 100
 Desc: Lean-to Heavy (LTH) Dimensions: 32x12 RMV: 1090
 Func Obsc: 100 Econ %: 100 Other %: 100 Exception: 0 Adjust: Adjust RMV: 0 N/C

Floors								
Type	Class	Display Group	Floor Size	Beds	Baths	Yr Blt	Eff Yr Blt	Inventory
Lean-to Heavy Duty	4	Finished	384	0	0	0	1995	Exception: Y N

Accessories						
Description	Class	Size SqFt	Eff Yr Blt	RMV	Quantity	
No accessory data available						

Bldg: 26 Code Area: 05545 Stat Class: 354 Year Blt: Eff Year Blt: 1995 Sq.Ft: 624 % Complete: 100
 Desc: Lean-to Light (LTL) Dimensions: RMV: 1060
 Func Obsc: 100 Econ %: 100 Other %: 100 Exception: 0 Adjust: Adjust RMV: 0 N/C

Floors						
---------------	--	--	--	--	--	--

Type	Class	Display Group	Floor Size	Beds	Baths	Yr Blt	Eff Yr Blt	Inventory
Lean-to Light Duty	4	Finished	624	0	0	0	1995	Exception: Y N

Accessories

Description	Class	Size SqFt	Eff Yr Blt	RMV	Quantity
No accessory data available					

Bldg: 27 Code Area: 05545 Stat Class: 354 Year Blt: Eff Year Blt: 1995 Sq.Ft: 200 % Complete: 100
 Desc: Lean-to Light (LTL) Dimensions: 20x10 RMV: 340
 Func Obsc: 100 Econ %: 100 Other %: 100 Exception: 0 Adjust: Adjust RMV: 0

N/C

Floors

Type	Class	Display Group	Floor Size	Beds	Baths	Yr Blt	Eff Yr Blt	Inventory
Lean-to Light Duty	4	Finished	200	0	0	0	1995	Exception: Y N

Accessories

Description	Class	Size SqFt	Eff Yr Blt	RMV	Quantity
No accessory data available					

Bldg: 28 Code Area: 05545 Stat Class: 354 Year Blt: Eff Year Blt: 1995 Sq.Ft: 180 % Complete: 100
 Desc: Lean-to Light (LTL) Dimensions: 18x10 RMV: 310
 Func Obsc: 100 Econ %: 100 Other %: 100 Exception: 0 Adjust: Adjust RMV: 0

N/C

Floors

Type	Class	Display Group	Floor Size	Beds	Baths	Yr Blt	Eff Yr Blt	Inventory
Lean-to Light Duty	4	Finished	180	0	0	0	1995	Exception: Y N

Accessories

Description	Class	Size SqFt	Eff Yr Blt	RMV	Quantity
No accessory data available					

Bldg: 29 Code Area: 05545 Stat Class: 355 Year Blt: Eff Year Blt: 2000 Sq.Ft: 2908 % Complete: 100
 Desc: Lean-to Heavy (LTH) Dimensions: 124x16, 66x14 RMV: 12250
 Func Obsc: 100 Econ %: 100 Other %: 100 Exception: 0 Adjust: Adjust RMV: 0

draw out

I/O

Floors

Type	Class	Display Group	Floor Size	Beds	Baths	Yr Blt	Eff Yr Blt	Inventory
Lean-to Heavy Duty	4	Finished	2908	0	0	0	2000	FAIR Exception: Y N

Accessories

Description	Class	Size SqFt	Eff Yr Blt	RMV	Quantity
No accessory data available					

355 LTH 2007 I/O

(3) HCS 1999 178x14' Fair
 (3) HCS 1999 193x14
 (3) HCS 1999 365x12
 (2) HCS 1999 365x30
 HCS 1999 365x16
 (2) HCS 1999 365x20
 HCS 1999 193x20'
 HCS 1999 365x16
 HCS 1999 365x20
 (4) HCS 1999 30x348
 HCS 1999 20x338
 (3) HCS 1999 40x210
 HCS 1999 30x210

was Bldg 7
 Gets MAD

I/O

SKETCH/AREA TABLE ADDENDUM

SUBJECT INFO

File No.: 564540 Parcel No.: 092W140000500
 Property Address: 7512 HUNSAKER RD SE
 City: TURNER County: Marion State: OR ZipCode: 97392
 Owner:
 Client: Client Address:
 Appraiser Name: Inspection Date:

SKETCH

564540
092W14 00500
SCALE 1:40

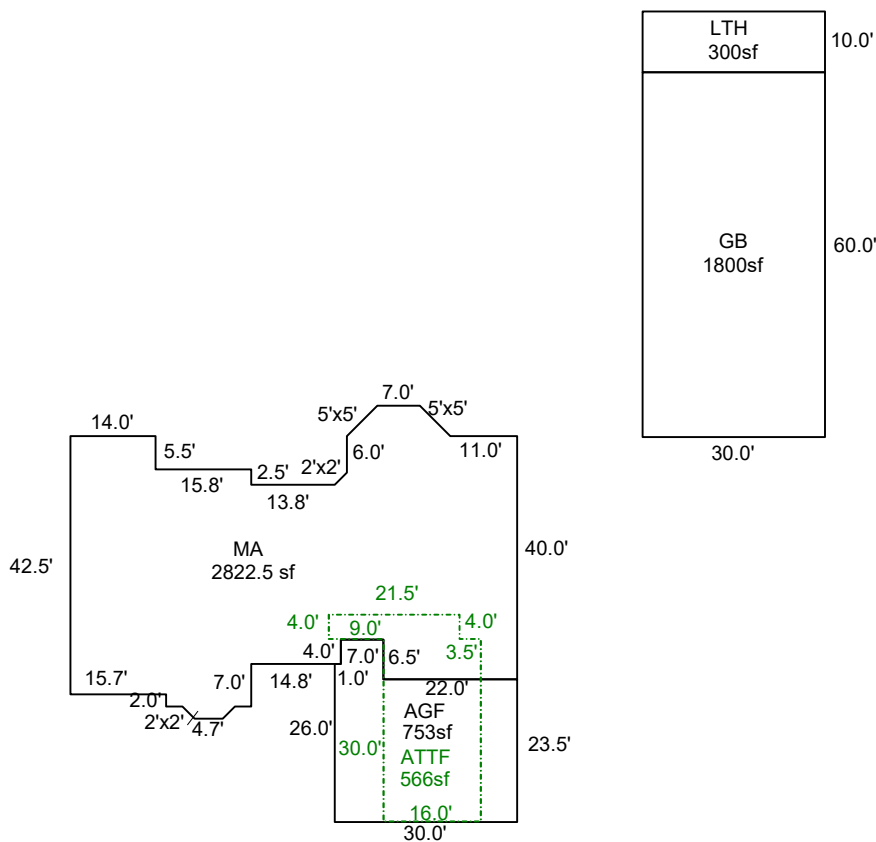

Sketch by ApexSketch

AREA CALCULATIONS SUMMARY

Code	Description	Factor	Net Size	Perimeter	Net Totals
GBA1	GB	1.0	1800.0	180.0	
	LTH	1.0	300.0	80.0	2100.0
GLA1	MA	1.0	2822.7	269.6	2822.7
GLA2	ATTF	1.0	566.0	118.0	566.0
GAR	AGF	1.0	753.0	120.0	753.0

COMMENT TABLE 1

EDITED BY NRC 02/20/2009
 UPDATED BY CLOBERG 08/19/25
 UPDATED BY CLOBERG 11/25/25

COMMENT TABLE 2

MLH 07/28/25

COMMENT TABLE 3

CLEAN UP L4

Net LIVABLE cnt 0 (rounded) 3,389
 Net BUILDING cnt 2 (rounded) 2,100

SKETCH/AREA TABLE ADDENDUM

SUBJECT INFO

File No.: 564540 Parcel No.: 092W140000500
 Property Address: 7512 HUNSAKER RD SE
 City: TURNER County: Marion State: OR ZipCode: 97392
 Owner:
 Client: Client Address:
 Appraiser Name: Inspection Date:

SKETCH

564540
092W140000500
SCALE 1:60

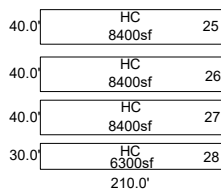
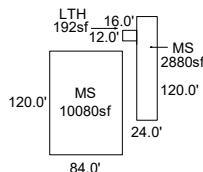
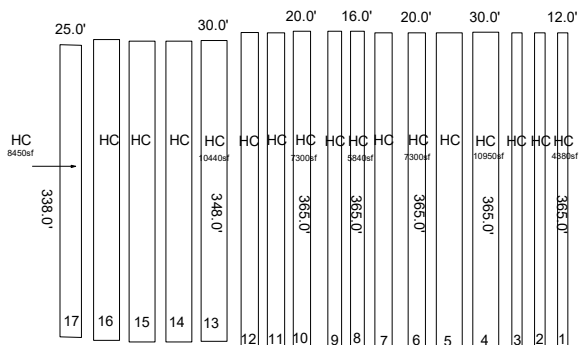

66.0'
27.0' MANF 1782sf

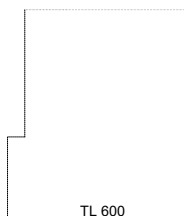
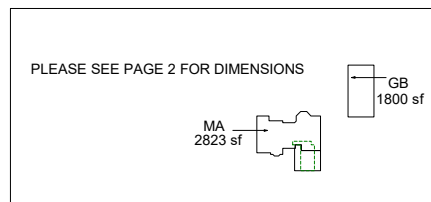
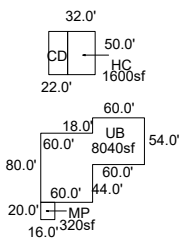
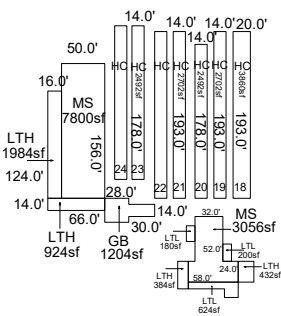

Sketch by ApexSketch

AREA CALCULATIONS SUMMARY

Code	Description	Factor	Net Size	Perimeter	Net Totals
GBA1	HC	1.0	8450.0	726.0	
	MS	1.0	10080.0	408.0	
	MS	1.0	2880.0	288.0	
	LTH	1.0	192.0	56.0	
	HC	1.0	2492.0	384.0	
	HC	1.0	2492.0	384.0	
	HC	1.0	2702.0	414.0	
	HC	1.0	2702.0	414.0	
	HC	1.0	2492.0	384.0	
	HC	1.0	2702.0	414.0	
	HC	1.0	3860.0	426.0	
	MS	1.0	3056.0	268.0	
	LTL	1.0	180.0	56.0	
	LTH	1.0	384.0	88.0	
LTL	1.0	624.0	152.0		
LTH	1.0	432.0	84.0		
33 addl items					
	Net LIVABLE	cnt	1 (rounded)		5,171
	Net BUILDING	cnt	45 (rounded)		226,072

COMMENT TABLE 1

EDITED BY NRC 02/20/2009 UPDATED BY CLOBERG 08/19/25	
COMMENT TABLE 2	COMMENT TABLE 3

SKETCH/AREA TABLE ADDENDUM

SUBJECT INFO

File No.: 564540 Parcel No.: 092W140000500
 Property Address: 7512 HUNSAKER RD SE
 City: TURNER County: Marion State: OR ZipCode: 97392
 Owner:
 Client: Client Address:
 Appraiser Name: Inspection Date:

SKETCH

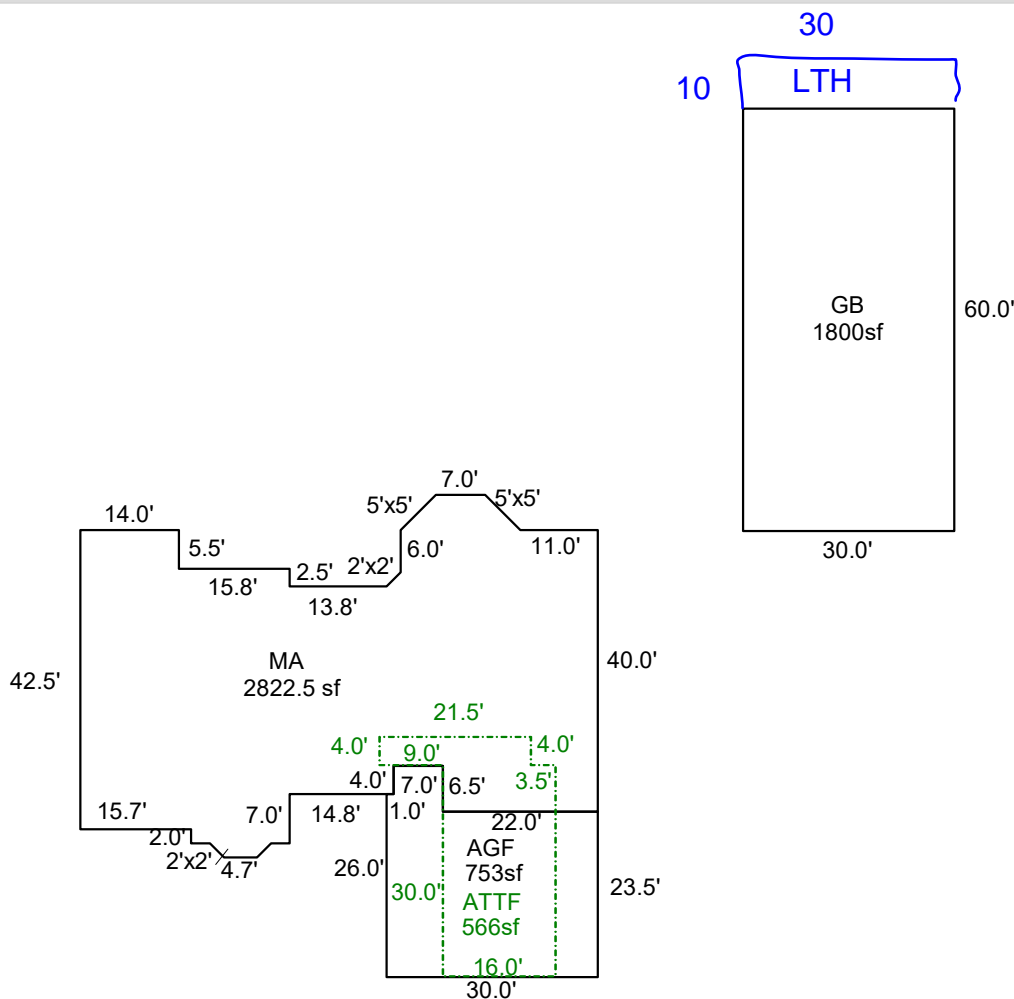

564540
 092W14 00500
 SCALE 1:40

Sketch by ApexSketch

AREA CALCULATIONS SUMMARY

Code	Description	Factor	Net Size	Perimeter	Net Totals
GBA1	GB	1.0	1800.0	180.0	1800.0
GLA1	MA	1.0	2822.7	269.6	2822.7
GLA2	ATTF	1.0	566.0	118.0	566.0
GAR	AGF	1.0	753.0	120.0	753.0

COMMENT TABLE 1

EDITED BY NRC 02/20/2009
 UPDATED BY CLOBERG 08/19/25

COMMENT TABLE 2

COMMENT TABLE 3

Net LIVABLE	cnt	0	(rounded)	3,389
Net BUILDING	cnt	1	(rounded)	1,800