

Summary

Lead Appr: _____ Clerk: _____ Lead Clerk: _____ Appr: _____

Print Date:

6/30/2025

Acct ID: 131237

MTL: 071W01C002400P1

Date: 8-26-25

Appr: GM

Prop Class: 019

RMV Prop Class: 019

Situs: 1307 S WATER ST # 89 SILVERTON, OR 97381

MaSaNh: 12 05 003

Unit: 142595

Year: 2025

Last Date Appraised: 07/27/2011

Appraiser: THERESA SWEARINGEN

Retag: Y N

Tag info:

2025- 2026

Owner: BOLTON, LOIS A

Roll Type: MS

Cycle: Tag Sales Verification Other: _____

Inspection level: 1 2 3 4

LCB

TTO

INSP

NOMIS

AV: 56040

RMV Land: 0

RMV Imp: 56040

RMV Total: 56040

MAV: 62110

MSAV: 0

SAV: 0

Comment: SILVERTON MOBILE HOME ESTATES, SPACE #89, MS SERIAL # 31910646YAB, X # X00202972, PERSONAL MS

Notations

No notation data available.

OSDs

No OSD data available.

Land

No land data available.

Improvements - Residence / Manufactured Structures

Bldg: 1 Code Area: 04020 Stat Class: 457 Year Blt: 1989 Eff Year Blt: 1989 Sq.Ft: 1512 % Complete: 100

Desc: MANUF STRUCT, CLASS 5, 26' THROUGH 28' WIDE DOUBLE

Dimensions: 56x27

RMV: 56040

Func Obsc: 100

Econ %: 100

Other %: 100

Exception: 0

Adjust:

Adjust RMV: 0

Floors

1496sf gm/lk 4.8.26

Type	Class	Display Group	Floor Size	Beds	Baths	Yr Blt	Eff Yr Blt	Inventory	Exception: Y N
First Floor	5	Finished	1512	3	FB-2	1989	1989	BATH - 2, KIT-, HVAC+, ROOF+, SKIRT	Y N

Accessories

Description	Class	Size SqFt	Eff Yr Blt	RMV	Quantity	Exception: Y N
DECK	5	200	1989	1628	0	Y N
ROOF EXTENSION OR PATIO COVER	5	348	1989	3734	0	Y N

Improvements - Accessory Buildings

No improvement data available for all other stat class types.



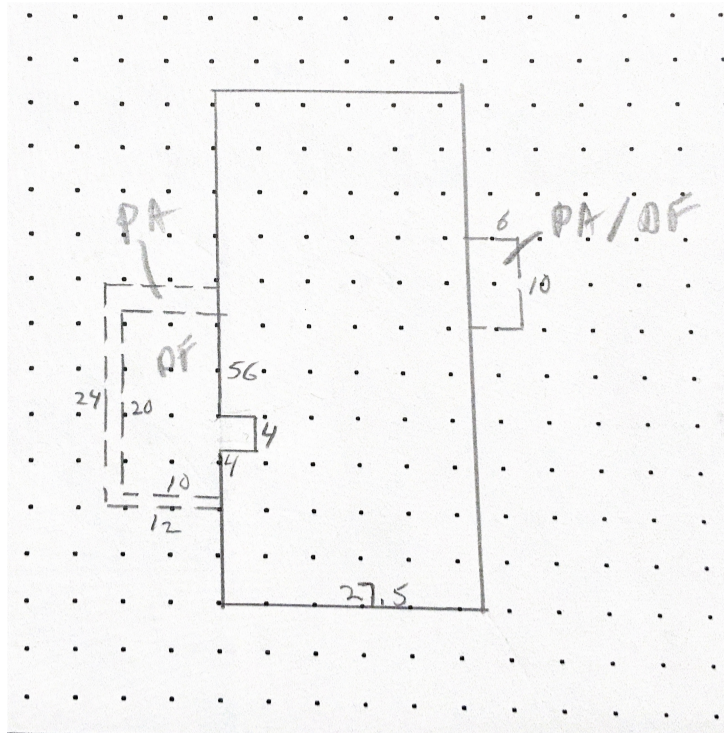

27

M131237 071W01C 02400 Appr #: 014 Date 7-27-11 Prop Class 019 Prop Code T57
 Situs Address 1307 S WATER ST, #89 Franchise Code 04 Year For: 2011-2012
 Owner BOLTON, LOIS A

Notes: N/C Tags Cycle Sales Verification Other: _____

RMV Imp: 28,200 RMV Total: 28,200 M50 Total: 28,200

Seg.Type MA	Seg. # 1.1	Method M04	Class 5D	Area 1512	Eff Area 1512	Length 56	Width 27
Make: SKYLINE	Model: HOMETTE	Intfinish: GYPSUM	Roof Cover ARCMP				
Plumbing BATH2	Heat AC	Fireplace	Inter. Comp: DW;H&F	Bedrooms 3			
Year Built 1989	Eff. Year Built 1989	Cond. P F <u>A</u> G E					
Adj Codes MSLCMD	Qty <u>5</u>	% Comp ___	Func ___	Econ ___	RMV 24,150		
Lump Sum _____	Except Code/Year _____	Comments _____					

Accessory Improvements

Seg.Type PA	Seg. # 1.3	Method: R05	Class	Area 348	Eff Area 348
Length	Width				
Year Built	Eff. Year Built: 1989	Cond. P F <u>A</u> G E	% Comp ___	Econ ___	RMV: 2,650
Lump Sum _____	Except Code/Year _____	Comments _____			

Seg.Type DF	Seg. # 1.4	Method: R05	Class	Area 200	Eff Area 200
Length 20	Width 10				
Year Built	Eff. Year Built: 1989	Cond. P F <u>A</u> G E	% Comp ___	Econ ___	RMV: 1,020
Lump Sum _____	Except Code/Year _____	Comments _____			

Out Buildings and Skirting

Seg.Type MHSK	Seg. # 1.2	Method: M04	Class	Area 166	Eff Area 166
Length	Width	Foundation	Ex. Wall METAL	Roof Cover	
Roof Style		Floor	Plumbing		
Heat	Int. Comp.	Elect.	Yr. Bilt. 1989	Eff. Yr. Bilt: 1989	
Cond. P F A G E	Adj. Codes	% Comp ___	Func ___	Econ ___	RMV: 380
Lump Sum _____	Except Code/Year _____	Comments _____			