

Acct ID: 129517 MTL: 071W01C002400P1 Date: **4/13/26** Appr: **ZH** Prop Class: 019 RMV Prop Class: 019

Situs: 1307 S WATER ST # 64 SILVERTON, OR 97381 MaSaNh: 12 05 003 Unit: 141881 Year: 2026

Last Date Appraised: 08/26/2025 Appraiser: THERESA SWEARINGEN Tag: Y N Tag info:

Owner: SCOTT, DEBORAH ELAINE Last Sales Date: 12/16/2025 Roll Type: MS

Cycle Tag **Sales Verification** Other: Inspection level: 1 **2** 3 4 **LCB** TTO INSP AV: 41840

RMV Land: 0 RMV Imp: 67830 RMV Total: 67830 MAV: 41840 MSAV: 0 SAV: 0

Comment: 25-26: Cycle; L3 08.26.25 GM

DELETE EP (SEE GONE), UPDATE EYB AS GOMAR / AT & ADD DECK SEG W/ EXCEPTION

Improvements - Residence / Manufactured Structures

1998 = GOMAR / AS

Bldg: 1 Code Area: 04020 Stat Class: 456 Year Blt: 1981 Eff Year Blt: ~~1995~~ Sq.Ft: 1440 % Complete: 100.00

Desc: MANUF STRUCT, CLASS 5, 24' WIDE DOUBLE Dimensions: 60x24 RMV: 67830

Func Obsc: 100 Econ %: 100 Other %: 100 Exception: 0 Adjust: Adjust RMV: 0 Subtype: P

Floors

Type	Class	Display Group	Floor Size	Beds	Baths	Yr Blt	Eff Yr Blt	Inventory	Exception
First Floor	5	Finished	1440	2	FB-2	1981	1995	BATH - 2, SKIRT, ROOF, HVAC+, KIT+, FP - 1	Y N

1998

Accessories

Description	Class	Size SqFt	Eff Yr Blt	RMV	Quantity	Exception
ENCLOSED PORCH GONE	3	256	1995	7354	0	Exception: Y N
ROOF EXTENSION OR PATIO COVER	5	90	1995	1096	0	Exception: Y N

- CERT. VALUE: \$91,410
- UPDATES WITHIN LAST 3 YEARS: FURNACE, HP, ROOF, DECKS, LAMINATE FLOORING, PAINT & 2 SHEDS
- VINYL WINDOWS SINCE BUILT
- ORIGINAL KIT./BATH CABS & COUNTERS
- ORIGINAL SIDING
- EYB BUMPED TO 1995 AFTER LAST CYCLE
- WHEEL CHAIR RAMP ADDED
- WELL MAINTAINED EXTERIOR



Segment	DF
Class	5
Dimensions/Size	224
Foundation	
Exterior Wall	
Interior Finish	
Roof Cover	
Roof Style	
Flooring	
Plumbing	
Heat	
Electric	
Misc.	
Year Built	2026
Eff. Year	1998 2026
Condition	
% Complete	100
Lump Sum	
Exception Code	NEW

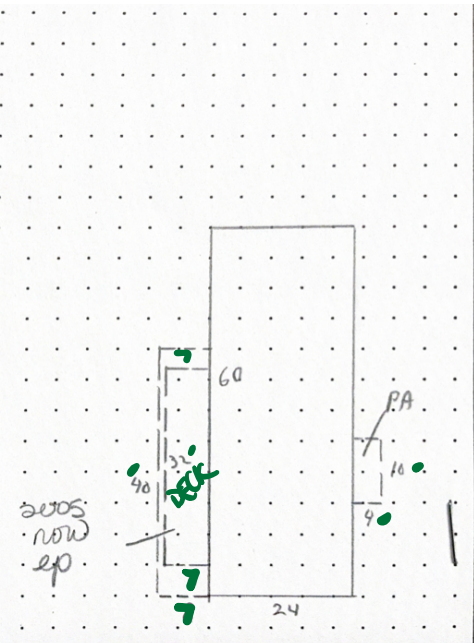

$PA = 7 \times 40 = 280$
 $4 \times 10 = 40$
 $\underline{\quad}$
 320
DECK = $7 \times 32 = 224$ SF



Marion County
OREGON
ASSESSOR'S OFFICE

Appraiser Sales Verification From

Primary Acct: 129517
MTL: 071W01C002400
MaSaNh/P.Class: 1205003/019
Appraiser: ZACK HARROLD
MS Acct: 129517

Date Printed: 3/10/2026

Situs: 1307 S WATER ST # 64 SILVERTON, OR 97381

Grantor:
STETSON, CYNTHIA LEE

Grantee:
SCOTT, DEBORAH ELAINE

Sale ID: Tax Statement RMV
Deed: Land & OSD: 0
Accts In Sale: Imp: 91410
Sale Date: 12/16/2025 Total: 91410
Sale Price: 159900 Ratio (Cert. Total RMV/Sale Price): 57
Condition Code: 00

Attempt	Date/Time	Reason
1 st	4/3/26 10:30	LCB
2 nd		

Contact: _____ Phone/email: _____

- Was the property listed on the open market? Days: 84 MLS: 833914 Y N
- Was property other than real estate included in the sale? Y N
Describe: _____ Est. \$: _____
- Did the seller pay closing costs or make other concessions? \$ _____ Y N
- Was the sale between related parties? (business or family) Y N
- Was this a distressed sale? E.g. foreclosure, short, court order, etc... Y N
- Condition at time of sale: | Poor | Fair | Avg. | Good | Exc. | Y N
Describe: _____

- Have any improvements been made since the time of sale? Y N
If yes, describe: _____

Comments: NO RESPONSE FROM HOME OWNER

Appraiser: ZH Date: 4/3/26

Summary

Lead Appr: _____ Clerk: _____ Lead Clerk: _____ Appr: **GM 9-9-25**

Print Date: 6/30/2025

Acct ID: 129517 MTL: 071W01C002400P1 Date: **8-26-25 GM** Prop Class: 019 RMV Prop Class: 019

Situs: 1307 S WATER ST # 64 SILVERTON, OR 97381 MaSaNh: 12 05 003 Unit: 141881 Year: ~~2025~~ **2026**

Last Date Appraised: 07/27/2011 Appraiser: THERESA SWEARINGEN Retag: Y N Tag info:

Owner: STETSON, CYNTHIA LEE Roll Type: MS

Cycle Tag Sales Verification Other: _____ Inspection level: 1 2 3 4 LCB TTO INSP **795135** AV: 40630

RMV Land: 0 RMV Imp: 48380 RMV Total: 48380 MAV: 40630 MSAV: 0 SAV: 0

Comment: SILVERTON MOBILE HOME ESTATES, SPACE #64, MS SERIAL # 9824, X # X00172099, PERSONAL MS

Update Inventory

Notations

No notation data available.

OSDs

No OSD data available.

Land

No land data available.

Improvements - Residence / Manufactured Structures

Bldg: 1 Code Area: 04020 Stat Class: 456 Year Blt: 1981 Eff Year Blt: 1981 Sq.Ft: 1440 % Complete: 100

Desc: MANUF STRUCT, CLASS 5, 24' WIDE DOUBLE Dimensions: 60x24 RMV: 48380

Func Obsc: 100 Econ %: 100 Other %: 100 Exception: 0 Adjust: Adjust RMV: 0

Floors

Type	Class	Display Group	Floor Size	Beds	Baths	Yr Blt	Eff Yr Blt	Inventory	Exception: Y N
First Floor	5	Finished	1440	2	FB-2	1981	1981	FP - 1, KIT+, HVAC+, ROOF, SKIRT, batn-2	Y N

995 EYB-GOMAN

Accessories

Description	Class	Size SqFt	Eff Yr Blt	RMV	Quantity	Exception: Y N
ENCLOSED PORCH	3	256	1981	2534	0	Exception: Y N
ROOF EXTENSION OR PATIO COVER	5	90	1981	861	0	Exception: Y N

GOMAN - will maintain

Improvements - Accessory Buildings

No improvement data available for all other stat class types.

MLS sold \$44,000 9/2022 (pics) Sold "As is", original exterior

