

SKETCH/AREA TABLE ADDENDUM

SUBJECT INFO

File No.: 613143 Parcel No.: 072W29BD05300
 Property Address: 4940 Elvis Ave NE
 City: Salem County: Marion State: OR ZipCode: 97301
 Owner:
 Client: Client Address:
 Appraiser Name: Inspection Date:

SKETCH

613143
072W29BD05300

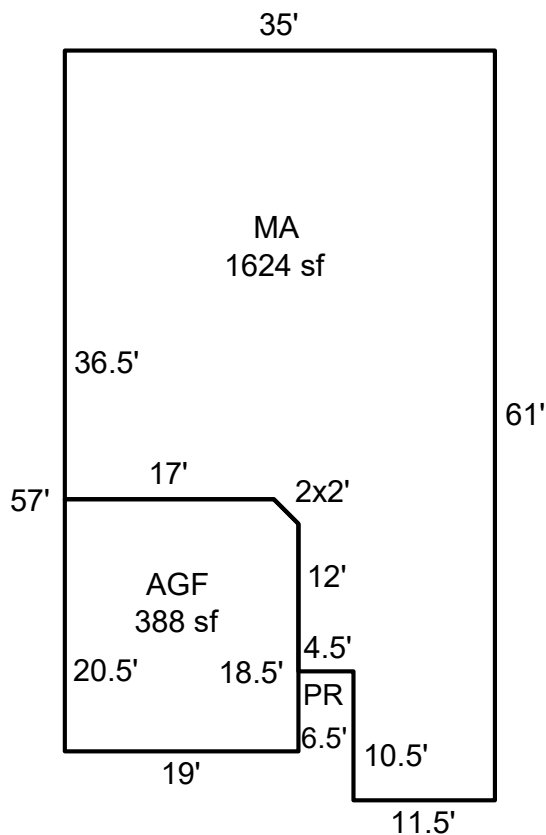

Sketch by ApexSketch

AREA CALCULATIONS SUMMARY

Code	Description	Factor	Net Size	Perimeter	Net Totals
GLA	MA	1.0	1624.3	190.8	1624.3
GAR	AGF	1.0	387.5	77.8	387.5

COMMENT TABLE 1

Drawn by AE 5.28.26

COMMENT TABLE 2

COMMENT TABLE 3

Net LIVABLE cnt 1 (rounded) 1,624