

# SKETCH/AREA TABLE ADDENDUM

## SUBJECT INFO

File No.: 613190 Parcel No.: 072W29BD10000  
 Property Address: 4933 Elvis Ave NE  
 City: Salem County: Marion State: OR ZipCode: 97301  
 Owner:  
 Client: Client Address:  
 Appraiser Name: Inspection Date:

## SKETCH

**613190**  
**072W29BD10000**

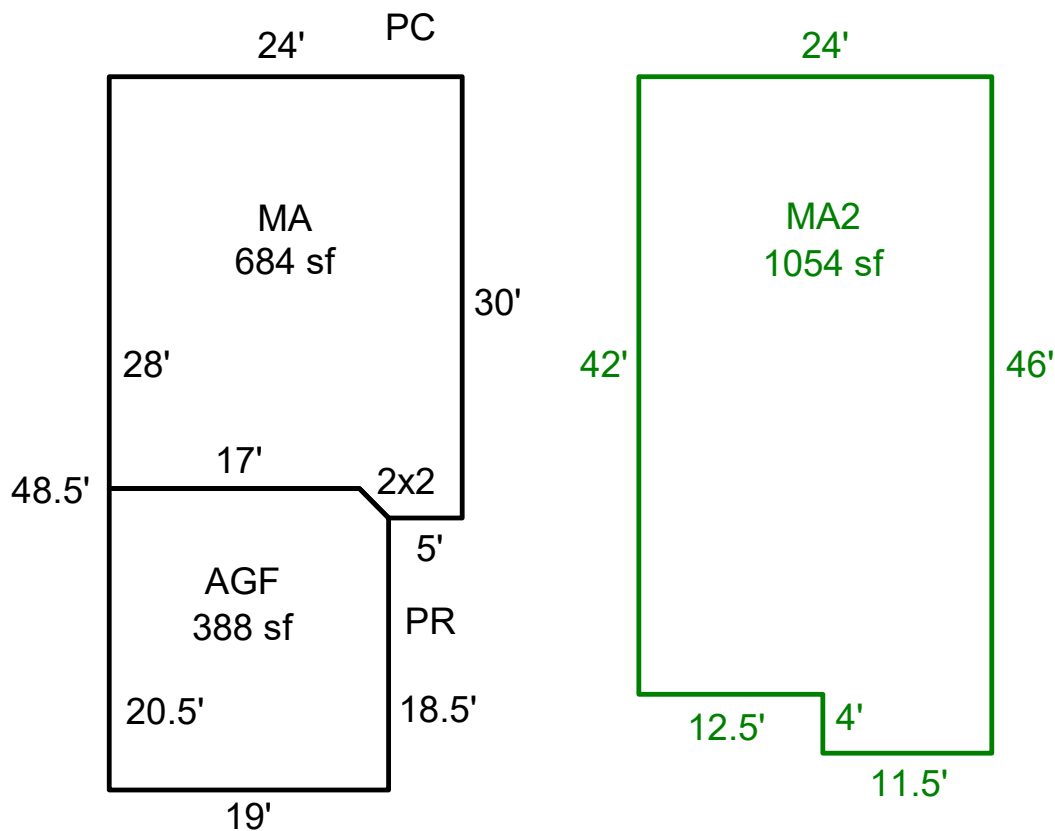

Sketch by ApexSketch

### AREA CALCULATIONS SUMMARY

Code	Description	Factor	Net Size	Perimeter	Net Totals
GLA	MA	1.0	684.0	106.8	684.0
GLA2	MA2	1.0	1054.0	140.0	1054.0
GAR	AGF	1.0	387.5	77.8	387.5

### COMMENT TABLE 1

Drawn by AE 5.28.26

### COMMENT TABLE 2

### COMMENT TABLE 3

Net LIVABLE                      cnt                      2      (rounded)                      1,738