

SKETCH/AREA TABLE ADDENDUM

SUBJECT INFO

File No.: 596664 Parcel No.: 083W14CB01500
 Property Address: 5613 Ross Ct SE
 City: Salem County: Marion State: OR ZipCode: 97306
 Owner:
 Client: Client Address:
 Appraiser Name: Inspection Date:

SKETCH

596664
083W14CB01500

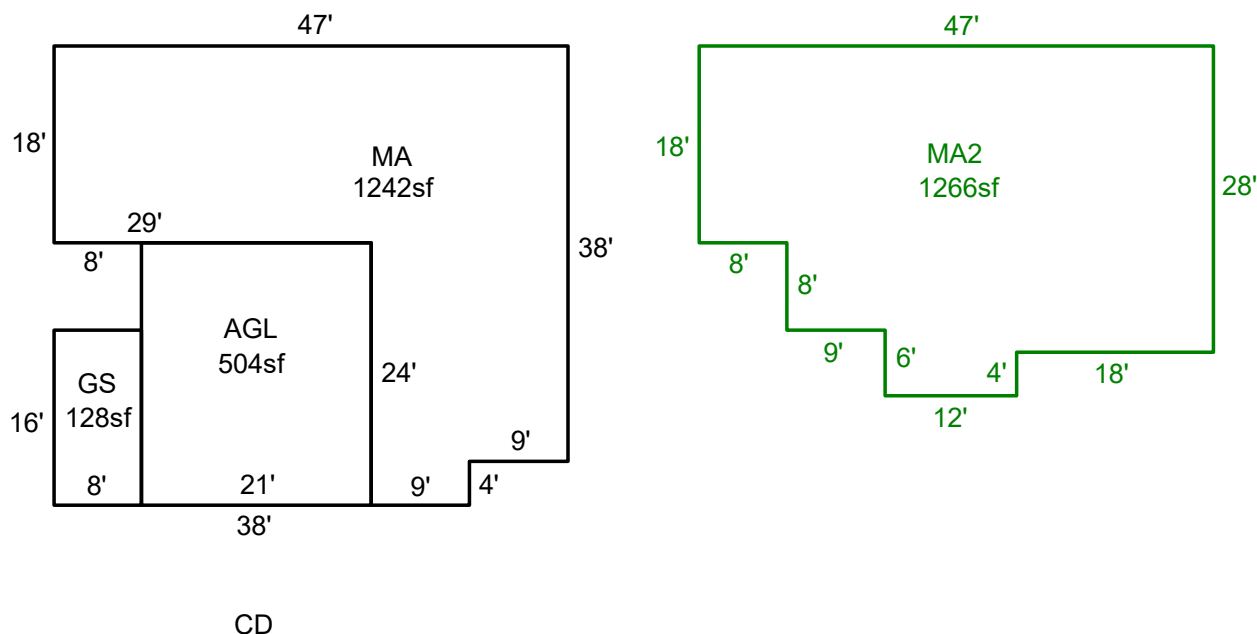

Sketch by ApexSketch

AREA CALCULATIONS SUMMARY

Code	Description	Factor	Net Size	Perimeter	Net Totals
GBA	GS	1.0	128.0	48.0	128.0
GLA	MA	1.0	1242.0	178.0	1242.0
GLA2	MA2	1.0	1266.0	158.0	1266.0
GAR	AGL	1.0	504.0	90.0	504.0

COMMENT TABLE 1

DRAWN BY SH 9-17-08
Updated by AE 6.10.26

COMMENT TABLE 2

4/20/23 #24 Cycle

COMMENT TABLE 3

Net LIVABLE	cnt	2	(rounded)		2,508
Net BUILDING	cnt	1	(rounded)		128