

DWG: C:\pwworking\projects\ae\daabott\063713\001_G-0019_715105.dwg USER: daabott
DATE: Aug 09, 2018 3:08pm XREFS:Salem Title Block ANSI D 1056B810C9101 714101PLANT5 X027-A-0104 702061-SITE X001-C-0102

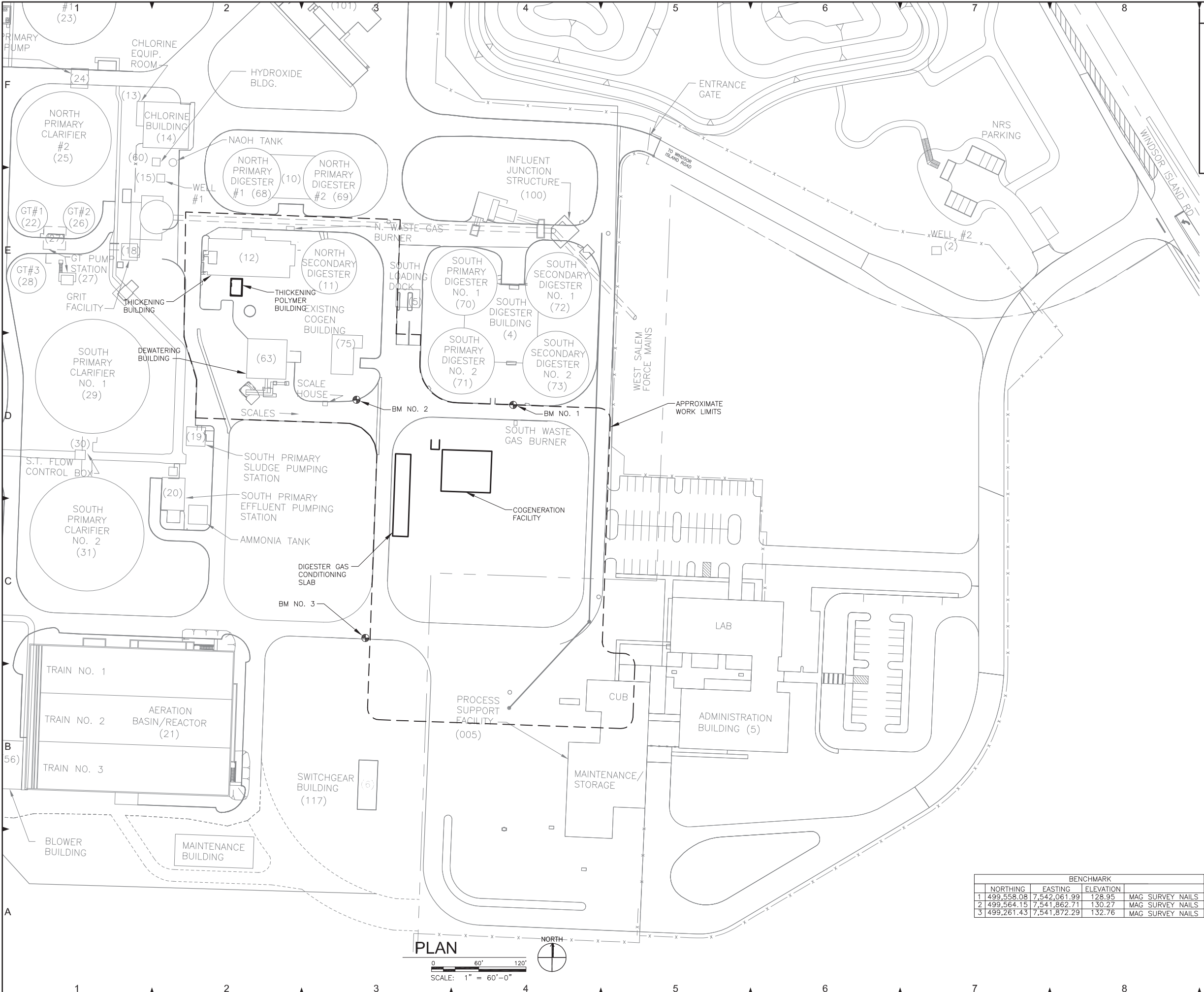

BENCHMARK				
	NORTHING	EASTING	ELEVATION	
1	499,558.08	7,542,061.99	128.95	MAG SURVEY NAILS
2	499,564.15	7,541,862.71	130.27	MAG SURVEY NAILS
3	499,261.43	7,541,872.29	132.76	MAG SURVEY NAILS

- GENERAL NOTES**
1. CONTRACTOR SHALL RESTORE ALL PAVEMENT, CURBING, IRRIGATION SYSTEMS, LANDSCAPING, AND GRASS AREAS TO EXISTING CONDITIONS AFTER COMPLETION OF WORK.
 2. ELEVATIONS ARE BASED ON RECOVERY OF THE USGS STATION "WILLOW" FROM PREVIOUS CONTROL NGVD1929.
 3. FIELD SURVEYED AUGUST 24TH, 2017.
 4. CONTRACTOR SHALL PROTECT SURVEY MONUMENTATION DURING CONSTRUCTION. NOTIFY PROJECT MANAGER BEFORE ANY MONUMENTS ARE TO BE BURIED OR REMOVED BY CONSTRUCTION ACTIVITIES.
 5. BASIS OF BEARINGS IS THE OREGON STATE PLANE COORDINATE SYSTEM, NORTH ZONE, NAD83 (2011).

CITY OF Salem
AT YOUR SERVICE

SHEET PREPARED BY:

carollo

Digitally signed by Matthew Sprick
DN: cn=Matthew Sprick, email=msprick@carollo.com, c=US, ou=Carollo Engineering, Inc., o=Carollo Engineering, Inc., ou=Carollo Engineering, Inc., email=msprick@carollo.com

REGISTERED PROFESSIONAL ENGINEER
81348
OREGON
JUNE 10, 2014
MATTHEW S. SPRICK
EXPIRES: 06/30/2020

CERTIFICATE EXPIRES:
DATE SIGNED:

VERIFY SHEET SIZE
BAR IS ONE INCH ON ORIGINAL DRAWING
0 1"
IF NOT ONE INCH, SHEET SIZE
HAS BEEN MODIFIED

COGENERATION AND SOLIDS IMPROVEMENTS AT WILLOW LAKE WATER POLLUTION CONTROL FACILITY

REVISIONS			
NO.	DESCRIPTION	DATE	BY

PROJECT NO: 715105
FILE NAME: 001_G-0019_715105
DATUM:
SURVEY:
HORIZ SCALE: AS
VERT SCALE: SHOWN
DESIGN: MSS
DRAWN: MJG
CHECKED: BJE

CHECKED: BH 9/10/18

SHEET TITLE

OVERALL SITE PLAN

G-0019.001

SHEET 7 OF 327